

Employer's Work Comp Guide

Orthopedics & Sports Medicine
BayCare Clinic in Manitowoc



To schedule same-day
Work Comp (WC)
evaluations in Manitowoc:
920-301-2667 (920-301-COMP)



ORTHOPEDICS &
SPORTS MEDICINE
BAYCARE CLINIC
MANITOWOC

Employer's Work Comp Guide

Orthopedics & Sports Medicine BayCare Clinic

- Table of contents -

Employer's work comp summary 3

How our work comp nurse helps you 4

Common causes of work comp injuries 5

Common injuries in work comp cases 6

Common treatment types 7

Meet your Manitowoc team 8

To schedule same-day WC evaluations in Manitowoc:
920-301-2667 (920-301-COMP)



Employer's work comp Summary

About our employer's work comp

Dedicated phone number specifically for WC cases.

Employer can call for same-day appointments (seen within 24 hours depending on time of phone call).

Same-day diagnostic imaging (X-rays and MRIs), depending on time of day.

Patient seen by either a physician or an advanced practice provider.

Human Resources and employee have direct phone access to WC coordinator and registered nurse Tiffany Jarchow at 920-682-6376, ext. 1831.

We treat worker's compensation injuries in a timely manner.

Avoid unnecessary Emergency Room visits, reducing costs and recovery time.

We work with the employer to help injured patients return to work quickly and safely.

Open to optimize return-to-work process.

We offer expert evaluation and comprehensive treatment options, including:

Rehab, splinting, injections, and surgery.

Our workers comp patients have direct access to one point of contact at our Manitowoc location.

Same-day appointments.

Guaranteed clinic appointment within 24 hours.

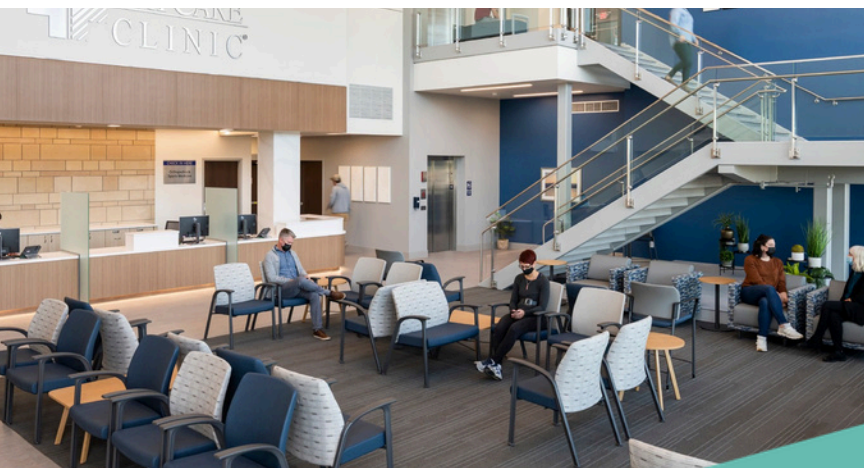

Worker's Compensation Coordinator contact information

Tiffany Jarchow, RN
Worker's Compensation Coordinator

Direct: 920-682-6376, ext. 1831

Fax: 920-652-0115

To schedule same-day WC
evaluations in Manitowoc:
920-301-2667 (920-301-COMP)

Tiffany Jarchow, RN
Worker's Compensation Coordinator

Direct: 920-682-6376, ext. 1831
Fax: 920-652-0115



How our work comp nurse helps you

- ▶ Tiffany attends office appointments with injured employee.

- ▶ She tracks all pertinent information on a WKC 16 industrial injury medical report from the Wisconsin Department of Workforce Development.
 - ▷ This form provides the medical documentation necessary for an employee to file a WC benefit claim in Wisconsin.

- ▶ Tiffany communicates with the employee's Human Resources team to update them on:
 - ▷ Status of patient's injury and treatment plan.
 - ▷ Communicate patient's concerns (such as not having any work to do while being on restrictions).
 - ▷ Future appointments.
 - ▷ Restrictions on returning to work, if any.
 - ▷ Getting the patient back to work as soon as safely possible.

To schedule same-day WC evaluations in Manitowoc:
920-301-2667 (920-301-COMP)



**ORTHOPEDECS &
SPORTS MEDICINE
BAYCARE CLINIC
MANITOWOC**



Common causes of work comp injuries

- ▶ Trips and/or falls
- ▶ Improper lifting mechanics
- ▶ Excessive repetitive use of upper or lower extremities

Many work-related injuries can be prevented.

We work closely with occupational therapists and any on-site managers to optimize on-the-job safety and work environment.

To schedule same-day WC evaluations in Manitowoc:
920-301-2667 (920-301-COMP)



ORTHOPEDICS &
SPORTS MEDICINE
BAYCARE CLINIC
MANITOWOC

Common injuries in work comp cases



Shoulder/elbow/hand

Carpal tunnel (hand/wrist)
Cubital tunnel
Elbow tendon tear
Epicondylitis (elbow)
Finger tip amputations
Fractures
Rotator cuff and/or bicep tendon tears (shoulder)



Hip

Labral tear
Tendon injuries



Knee and leg

Ligament tears
Meniscus/cartilage tear
Muscle strain
Patella fracture
Tendon tears
Tibia/fibia fracture



Foot and ankle

Achilles tendon tear
Ankle fracture
Ankle sprain
Foot fractures



To schedule same-day WC evaluations in Manitowoc:
920-301-2667 (920-301-COMP)



ORTHOPEDECS &
SPORTS MEDICINE
BAYCARE CLINIC
MANITOWOC

Employer's work comp Common treatment types

We have the tools, experts and experience needed to evaluate and treat any orthopedic injury or overuse condition.

Treatment goals

To return the injured employee back to work (in some sort of capacity) as soon as safely possible. Favor conservative treatment when appropriate; surgery only when necessary.

Keep employer up to date on patient's progress, ability to work, and prognosis.

Guide successful post-injury rehab.

Non-surgical treatment options

- ▷ Injections
- ▷ Physical or occupational therapy
- ▷ Splint or brace
- ▷ Durable medical equipment
- ▷ (DME) Regenerative medicine



To schedule same-day WC
evaluations in Manitowoc:
920-301-2667 (920-301-COMP)



Jason George DeVries, DPM
Fellowship Trained
Foot and Ankle Surgeon



Carl A. DiRaimondo, MD
Orthopedic Surgeon
Sports Medicine Specialist



Jon Henry, MD
Orthopedic Surgeon
Sports Medicine Specialist



Brian J. Klika, MD
Orthopedic Surgeon
Hand Specialist



Brian Kurcz, MD
Orthopedic Surgeon
Sports Medicine Specialist



Craig L. Olson, MD
Orthopedic Surgeon
Shoulder and Sports
Medicine Specialist



Ryan Woods, MD, RMSK
Sports Medicine and
Regenerative Medicine
Specialist



Ashley Ford, PA-C



Maggie Fuhrman, PA-C



Stacey Hladish, PA-C

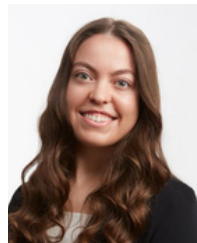

Michelle Mironovich, PA-C



Nicholas M Pflum, DNP



Alex Riegelman, APNP



Dakota Wehausen, PA-C

Meet Your Manitowoc Team

Our providers are experts in treating many orthopedic conditions.

We offer:

- Joint replacement surgery
- Carpal tunnel
- Elbow dislocation surgery
- Knee arthroscopy
- Hip arthroscopy
- Shoulder arthroscopy
- Ankle arthroscopy
- Fracture care
- Rotator cuff surgery and rehabilitation
- Foot and ankle repair surgery
- Elbow, wrist and hand surgery
- Knee ligament reconstruction
- Regenerative medicine
- Non-operative treatments
- Cartilage repair
- Arthritis treatment
- In-office procedures:
 - ▷ Ganglion cyst removal
 - ▷ Carpal tunnel release
 - ▷ Trigger finger release

To schedule same-day WC evaluations in Manitowoc:
920-301-2667 (920-301-COMP)



**ORTHOPEDECS &
SPORTS MEDICINE
BAYCARE CLINIC
MANITOWOC**